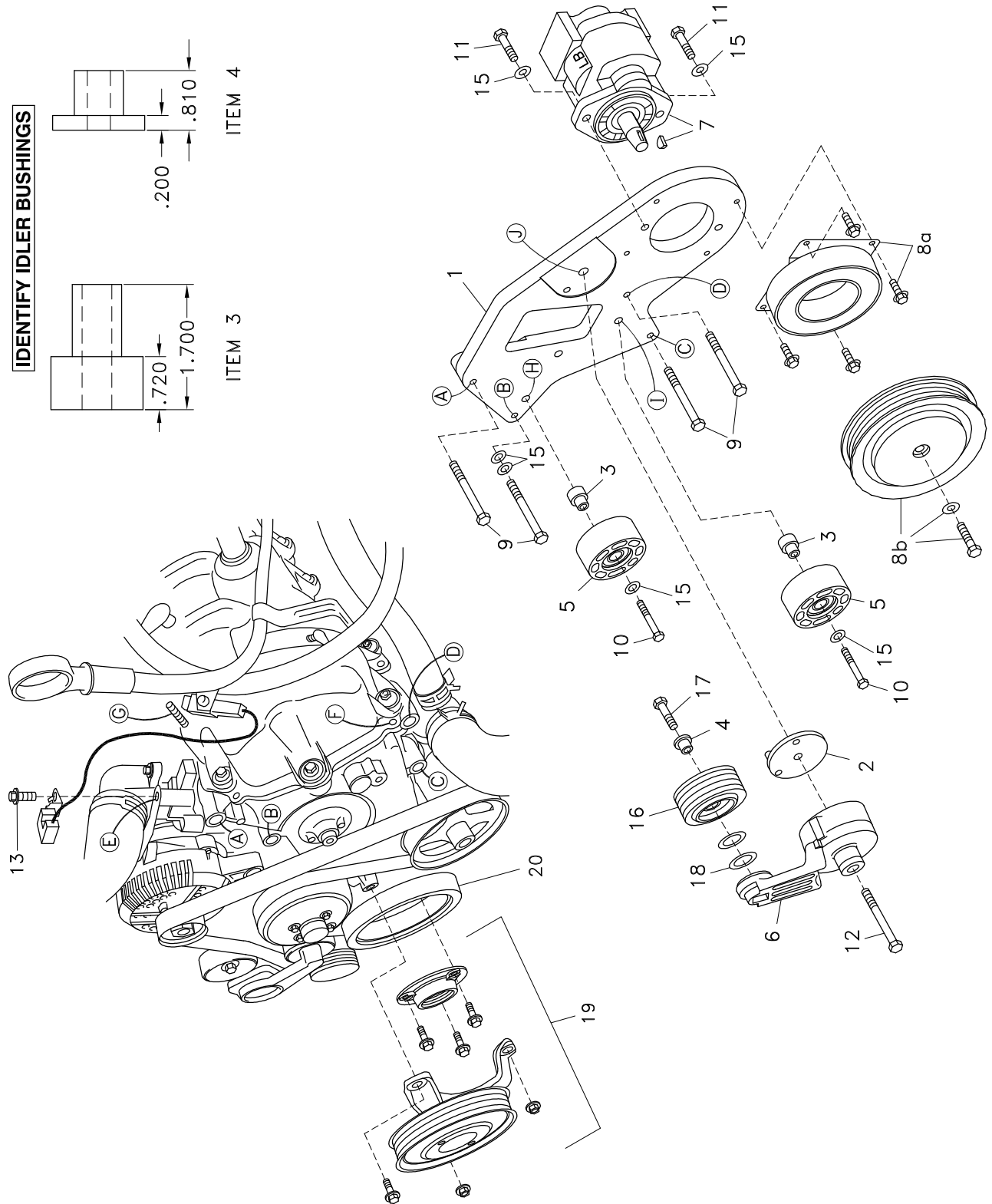
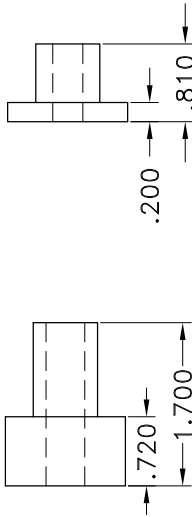



**FIG. 3**

**IDENTIFY IDLER BUSHINGS**



# DewEze

## Clutch Pump Kit

Clutch Pump Kit  
700434  
Ford 6.8  
F-450, F-550  
Spider drive  
2005+

# INSTALLATION INSTRUCTIONS

---

1. Disconnect the battery.
2. Remove the air cleaner assembly.
3. Drain the radiator. Remove the top radiator hose.
4. Remove the fan and shroud.
5. Remove the three OEM stud bolts from Locations A, C, and D. Remove one OEM bolt from Location B.
6. Remove the OEM bolt (13) from the front of the thermostat housing (Location E), place the OEM electrical wire as shown there and fasten with the OEM bolt.
7. Remove the wiring harness from the attachment points on the valve cover at the front corner (Location F) and the stud bolt under the air tube (Location G). Push the wiring harness back on top of the valve cover to clear the pump and bracket.
8. Refer to Fig. 2: Clamp off the large suction hose coming from the power steering reservoir. This will keep the fluid from running out the ports when the lines are loosened. Remove both lines from the top of the power steering box for easier access. On the hose that was closest to the engine, cut the steel line just at the start of the first bend from the end of the hose. Slide the nut, then the ferrule onto the tube and attach that to the new hose (24). Thread the adapter (23) into the steering box pointing it down toward the front of the truck. Thread the other end of the hose into the adapter. Replace the OEM line farthest from the engine without modification. Tighten all connections. Remove the clamp.
9. Install the crank damper (20) and spider drive (19). Replace the OEM water pump with the new water pump with extended hub, using the original water pump pulley over. Refer to the separate sheets for these procedures.
10. Attach the pump (7) to the back of the pump plate (1) using two 3/8 x 1 1/4 bolts (11) and two 3/8 flat washers (15).
11. Attach the clutch coil (8a) to the front of the pump plate using the four 1/4 x 1/2 flange bolts provided with the clutch. Attach the clutch pulley (8b) to the pump shaft using the 5/16 x 1 1/4 bolt and heavy flat washer provided with the clutch.
12. Place the two 1" O.D. x .668" I.D. shims (18) on the boss on the tensioner arm (6). Place the 8-groove idler pulley (16) on that boss. Insert the idler bushing (4, .200" flange) into the center of the idler. Hold it on with the M8 x 40 bolt (17). Place the tensioner spacer (2) on the pump plate at Location J inserting the pin into the hole in the plate. Place the tensioner (6) on the spacer using the M12 x 75 bolt (12) placing the locating pin in the hole in the spacer.
13. Attach the pump plate to the engine at Locations A, B, C, and D with four M10 x 120 bolts (9). Place two 3/8 flat washers (15) on the bolt at Location B.
14. Attach one flat idler (5) to the plate with the M10 x 60 bolt (10) and 3/8 flat washer (15) with an idler bushing (3, .720" thick flange) at Location H. Attach the other flat idler (5) with an M10 x 60 bolt (10) and 3/8 flat washer (15) and idler bushing (3) at Location I.
15. Install the new serpentine belt (23) as shown in Fig. 1.
16. Replace the fan and shroud.
17. Replace the radiator hose and the coolant.
18. Connect the battery.
19. Run the engine and check for any clearance or alignment problems. Adjust as needed.